

Accessories

Bits | Sockets | Inserts | Bushes

**Accessories for air and
electric screwdrivers
and nutrunner motors**



PEOPLE AND SOLUTIONS

Reliability

Be demanding

Productivity

Don't be satisfied
with the maximum

Ergonomics

Perfection is
in your hands

Ecology

Naturally
innovative

FIAM ACCESSORIES. A VALUABLE CHOICE

Fiam accessories represent a 'valuable choice' because they are designed and built to guarantee **long life, great reliability and the best performances** of the air and electric tools.

These advantages results in less maintenance and repair costs and a considerable increase of the **efficiency of the productive cycles**.

Alike all Fiam solutions, accessories **respect ergonomic criterias and maximum operator's safety**; they are designed with great attention to **environment safeguard**.

Available in customized version based on the customer's requirements, they are able to satisfy every customer's need.

Selection of tool, accessory and compliance with correct way of use are the factors that highly contribute in warranting "job quality", by means of an ergonomic workplace design: an essential base of worker health, productivity and finished product quality.

FIAM SERVICE: ALWAYS CLOSE TO ITS CUSTOMER

Fiam, together with its solutions, offers a wide range of **services in order to optimize, in terms of safety and ergonomics, the productive processes of its customers**: from the choice of the tools and the accessories to the suggestions about correct operator's posture and the correct use of ergonomic tools.

For all further details, please apply to Fiam Technical Consultancy Service.



Ergotech project

Having full knowledge of the ergonomics needs and of the safety of the operator, Fiam optimizes the performances of its tools and offers consulting and qualified training for the correct use

To deepen the issues on ergonomics and safety in industrial tightening operations, ask to Fiam Customer Service info@fiamgroup.com for reading our publication.



Accessories for every productive need

These accessories are manufactured with high-quality materials through precise and accurate processing that, together the treatments, guarantees **great resistance to breakage and wear**.

Namely, these treatments prevent dimensional changes and warrantee **resistance to torsion loads conveying to the screw the greatest part of torque the screwdriver supplies, avoiding dispersion**.

The models are **suitable for different types of screws, nuts, bolts** existing on the market (with the different heads or imprints: hexagonal, slotted, cross-slotted...) and they can have different dimensions depending on the production needs.

Special customized accessories based on the customer's drawing are available upon request.

For all further details, please apply to the **Fiam Technical Consultancy Service**.

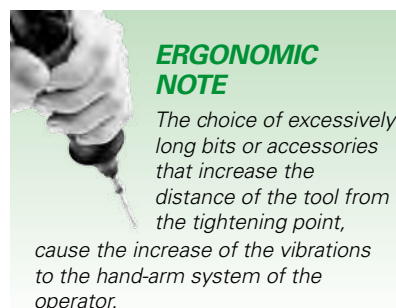

INDEX

ACCESSORIES FOR ALLEN HEAD SCREWS.....	4
ACCESSORIES FOR HEXAGONAL HEAD SCREWS AND NUTS.....	5
ACCESSORIES FOR SLOTTED HEAD SCREWS.....	6
ACCESSORIES FOR TORX HEAD SCREWS.....	6
ACCESSORIES FOR PHILLIPS HEAD SCREWS.....	7
ACCESSORIES FOR POZIDRIV HEAD SCREWS.....	7
ADAPTERS FOR ANGLE NUTRUNNERS.....	8

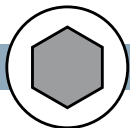

ACCESSORIES FOR ALLEN HEAD SCREWS



Socket for allen head screws

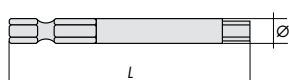

Hex. mm	2	2.5	3	4	5	6	7	8	9	10
Ø socket mm - L= 50 mm Cod. 605222...	Ø 6 ...020	Ø 6 ...025	Ø 6 ...030	Ø 5 ...040	Ø 8 ...050	Ø 8 ...060	Ø 10 ...070	Ø 9 ...080	Ø 11 ...090	Ø 12 ...100
Ø socket mm - L= 70 mm Cod. 605223...	Ø 3 ...020	Ø 4 ...025	Ø 4 ...030	Ø 5 ...040	Ø 6 ...050	Ø 8 ...060	Ø 8 ...070	Ø 9 ...080	Ø 12 ...090	Ø 12 ...100



1/4"
3/8"
1/2"
3/4"
1"

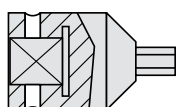

Socket for allen head screws



Hex. mm	2	2,5	3	4	5	6	7	8	9	10
Cod. 625221...	...020	...025	...030	...040	...050	...060	...070	...080	...090	...100
Hex. mm	4	5	6	7	8	9	10			
Cod. 626221...	...040	...050	...060	...070	...080	...090	...100			
Hex. mm	5	6	8	10	12	14				
Cod. 627221...	...050	...060	...080	...100	...120	...140				
Hex. mm	8	10	12	14	17	19				
Cod. 628221...	...080	...100	...120	...140	...170	...190				
Hex. mm	17	19	24							
Cod. 629221...	...001	...002	...004							



1/4"

Adapter

L= 50 mm - Cod. 605251140
L= 100 mm - Cod. 605252140

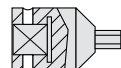
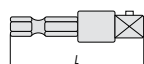

Socket for allen head screws

Hex. mm	2	2.5	3	4	5	6	7	8	9	10
Socket Cod. 625221...	...020	...025	...030	...040	...050	...060	...070	...080	...090	...100



1/4"

Adapter

L= 50 mm - Cod. 605251380
L= 100 mm - Cod. 605252380

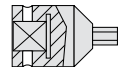
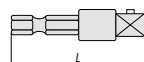

Socket for allen head screws

Hex. mm	4	5	6	7	8	9	10
Socket Cod. 626221...	...040	...050	...060	...070	...080	...090	...100



1/4"

Magnetic bit holder

L= 72 mm - Cod. 605101140

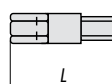
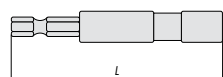

Inserts bit for allen head screws

Hex. mm	2	2.5	3	4	5	6	8
Inserts - L= 25 mm Cod. 606221...	...020	...025	...030	...040	...050	...060	...080



12 mm

Socket for allen head screws
L= 45 mm for AN...S

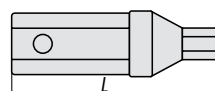

Hex. mm	4	6	8	10	12
Socket Cod. 616221...	...040	...060	...080	...100	...120



1/4"

Socket for allen head screws
L= 22 mm for A6RSA1 e A6RS1

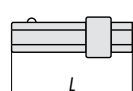

Hex. mm	2.5	3	4	5	6
Socket Cod. 607221...	...025	...030	...040	...050	...060



14 mm

Socket for allen head screws
L= 29 mm for A...RY e A10RYA

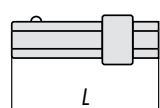

Hex. mm	4	5	6	8	10
Socket Cod. 618221...	...040	...050	...060	...080	...100

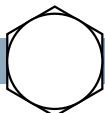

ACCESSORIES FOR HEXAGONAL HEAD SCREWS AND NUTS



Socket for hexagonal head screws



Upon request available with built-in magnet

Hex. mm	4	4,5	5	5,5	6	7	8	9	10	11	12	13	14	17
Socket - L= 50 mm Cod. 605151...	...040	...045	...050	...055	...060	...070	...080	...090	...100	...110	...120	...130	...140	...170
Socket - L= 75 mm Cod. 605156...	...040	...045	...050	...055	...060	...070	...080	...090	...100	...110	...120	...130	...140	...170
Socket - L= 100 mm Cod. 605152...	...040	...045	...050	...055	...060	...070	...080	...090	...100	...110	...120	...130	...140	...170

Adapter

L= 50 mm - Cod. 605251140
L= 100 mm - Cod. 605252140

Hex. mm	4	4,5	5	5,5	6	7	8	9	10	11	12	13
Socket Cod. 625151...	...040	...045	...050	...055	...060	...070	...080	...090	...100	...110	...120	...130

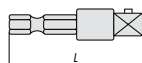

Socket for hexagonal head screws

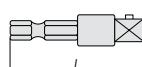

Adapter
L= 50 mm - Cod. 605251380
L= 100 mm - Cod. 605252380

Socket for hexagonal head screws

Hex. mm	7	8	9	10	11	12	13	14	15	16	17	18	19
Socket Cod. 626151...	...070	...080	...090	...100	...110	...120	...130	...140	...150	...160	...170	...180	...190

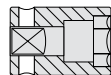

Socket for hexagonal head screws



Hex. mm	8	9	10	11	12	13	14	15	16	17	18	19	21	22	24	27
Socket Cod. 627151...	...080	...090	...100	...110	...120	...130	...140	...150	...160	...170	...180	...190	...210	...220	...240	...270



Hex. mm	17	18	19	21	22	24	27	30	32	34	36	41	46
Socket Cod. 628151...	...170	...180	...190	...210	...220	...240	...270	...300	...320	...340	...360	...410	...460



Hex. mm	22	24	27	30	32	34	36	41	46	50	55	60	65	70
Socket Cod. 629151...	...220	...240	...270	...300	...320	...340	...360	...410	...460	...500	...550	...600	...650	...700

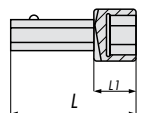

Socket for hexagonal head screws
L= 22 mm
L₁= 8 mm
for A6RS1

Hex. mm	5	6	7	8	9	10	11	13
Socket - L= 22 mm Cod. 607151...	...050	...060	...070	...080	...090	...100	...110	...130

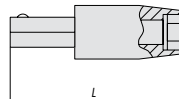

Socket for hexagonal head screws
L= 60 mm for AN...S

Hex. mm	8	10	11	13	14	17	19	22
Socket - L= 60 mm Cod. 616151...	...080	...100	...111	...113	...114	...117	...119	...122

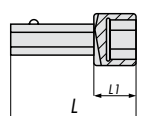

Socket for hexagonal head screws
L= 29 mm
L₁= 10 mm
for A...RY and A10RYA

Hex. mm	8	9	10	12	13	14	17	19	22
Socket - L= 29 Cod. 618151...	...080	...090	...100	...120	...130	...140	...170	...190	...220

Upon request available hexagon with different outputs.

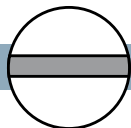

ACCESSORIES FOR SLOTTED HEAD SCREWS



Bit for slotted screws

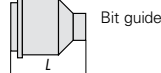
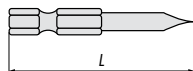

Bit guide

ø head screw mm	min.	2,1	2,6	3,1	3,6	4,1	4,6	5,1	5,6	6,1	6,6	7,1	8,1	9,1	10,1
	max.	2,5	3	3,5	4	4,5	5	5,5	6	6,5	7	8	9	10	11
ø Bit mm		2	2,5	3	3,5	4	4,5	5	5,5	6	6,5	7	8	9	10
Bit L= 50 mm Cod. 605011...		...020	...025	...030	...035	...040	...045	...050	...055	...060	...065	...070	...080	...090	...100
Bit guide L=22 mm Cod. 638431...				...030	...035	...040	...045	...050	...055	...060	...065	...070	...080	...090	...100
Bit L= 70 mm Cod. 605016...		...020	...025	...030	...035	...040	...045	...050	...055	...060	...065	...070	...080	...090	...100
Bit guide L= 47 mm Cod. 638435...				...030	...035	...040	...045	...050	...055	...060	...065	...070	...080	...090	...100

Transformat. Kit	Code
Bush and spring	303007160

* Kit for the use of guide on bit for slotted head screws

ø Inserts mm	2	2,5	3	3,5	4	4,5	5	5,5	6	6,5	7	7,5	8	8,5	9	10
L= 39 mm Cod. 606011...	...020	...025	...030	...035	...040	...045	...050	...055	...060	...065	...070	...075	...080	...085	...090	...100

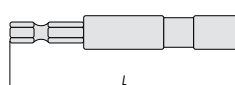

Magnetic bit holder
L= 72 mm - Cod. 605101140

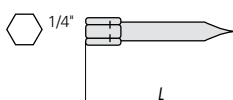

Insert bit for slotted head screws



Bit with built-in bush

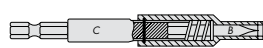

A - Retractable bush guide
B - Insert bit for slotted head screws
C - Magnetic bit holder:
Cod. 605101140

ø head screw mm	min.	2,1	2,6	3,1	3,6	4,1	4,6	5,1	5,6	6,1	6,6	7,1	8,1
	max.	2,5	3	3,5	4	4,5	5	5,5	6	6,5	7	8	9
Retractable bush guide L= 47 mm Cod. 642432...		...025	...030	...035	...040	...045	...050	...055	...060	...065	...070	...080	...090
Insert bit for slotted head screws L= 39 mm Cod. 606011...		...020	...025	...030	...035	...040	...045	...050	...055	...060	...065	...070	...080

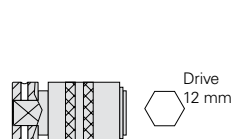

Quick change chuck
drive 3/8" F Cod. 659811001
drive 1/2" F Cod. 659911001

ø head screw mm	9	10	11	13-14	16	17-18	19-20	21-22	23-24
Bit - L= 92 mm Cod. 617011...	...085	...095	...105	...125	...150	...160	...180	...200	...220

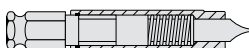

Bit for slotted head screws and built-in guide for quick change chuck - L= 92 mm



ACCESSORIES FOR TORX HEAD SCREWS

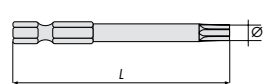

Socket for Torx slot screws

Torx	T10	T15	T20	T25	T27	T30	T40
Ø Socket mm - L= 50 mm Cod. 605081...	Ø 6 ...100	Ø 6 ...150	Ø 6 ...200	Ø 6 ...250	Ø 6 ...270	Ø 6 ...300	Ø 7,5 ...400

Torx	T8	T9	T10	T15	T20	T25	T27	T30	T40
Insert bit - L= 25 mm Cod. 606081...	...080	...090	...100	...150	...200	...250	...270	...300	...400

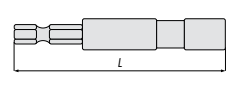

Magnetic bit holder
L= 72 mm - Cod. 605101140

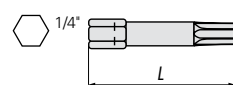

Insert bit for Torx slot screws



ACCESSORIES FOR PHILLIPS HEAD SCREWS



1/4"

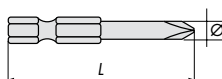

Bit for crossslot screws

Phillips	N. 0	N. 1	N. 2	N. 3
Ø bit mm L= 50 mm - Cod. 605051...	Ø 3 ...030	Ø 4,5 ...101	Ø 6 ...102	Ø 6 ...103
Ø bit mm L= 75 mm - Cod. 605052...	Ø 3 ...030	Ø 4,5 ...101	Ø 6 ...102	Ø 8 ...103
Ø bit mm L= 100 mm - Cod. 605053...	Ø 3 ...030	Ø 4,5 ...001	Ø 6 ...002	Ø 6 ...003



1/4"

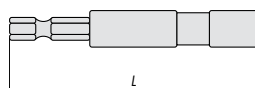

Magnetic bit holder
L= 72 mm - Cod. 605101140

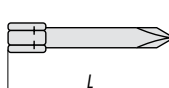

Insert bit for crossslot screws

Phillips	N. 1	N. 2	N. 3
Insert bit L= 25 mm - Cod. 606051...	...201	...202	...203



1/4"

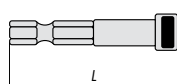

Double bit holder
L= 54 mm - Cod. 605401000

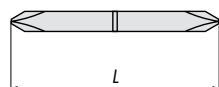

Double insert bit for crossslot screws

Phillips	N. 1	N. 2	N. 3
Double insert bit L= 50 mm - Cod. 630052...	...001	...002	...003



ACCESSORIES FOR POZIDRIV HEAD SCREWS



1/4"

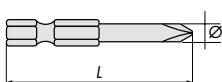

Bit for crossslot screws

Pozidriv	N. 1	N. 2	N. 3
Ø bit mm L= 50 mm - Cod. 605061...	Ø 4,5 ...001	Ø 6 ...002	Ø 8 ...003
Ø bit mm L= 75 mm - Cod. 605062...	Ø 4,5 ...101	Ø 6 ...102	Ø 8 ...103
Ø bit mm L= 100 mm - Cod. 605063...	Ø 4,5 ...001	Ø 6 ...002	Ø 8 ...003



1/4"

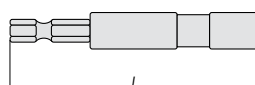

Magnetic bit holder
L= 72 mm - Cod. 605101140

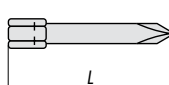

Insert bit for crossslot screws

Pozidriv	N. 1	N. 2	N. 3
Insert bit L= 25 mm - Cod. 606061...	...201	...202	...203



1/4"

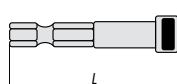

Double bit holder
L= 54 mm - Cod. 605401000



Double insert bit for crossslot screws

Pozidriv	N. 1	N. 2	N. 3
Double insert bit L= 50 mm - Cod. 630052...	...101	...102	...103

ADAPTERS FOR ANGLE NUTRUNNERS

Easy to use accessories which permit to use the angle nutrunners also with sockets and insert bits, owned by the Customer, having different drive with respect to the nutrunner.

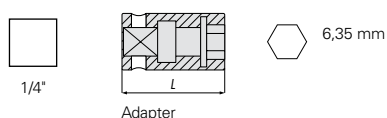

Drive	L = mm	Code
○ for 1/4" non magnetic insert bit	25	625111140
○ for 1/4" magnetic insert bit	36	625101140

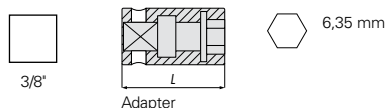

Drive	L = mm	Code
○ for 1/4" non magnetic insert bit	35	626111140
○ for 1/4" magnetic insert bit	52	626102064
○ for 1/4" quick change bits	42	626140001

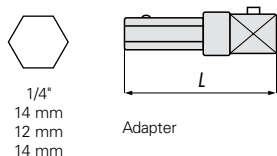

Drive	For	L = mm	Code
□ 1/4"	A6RSA1 and A6RS1	24	607251140
□ 3/8"	A10RYA and A...RY1	32	618251380
□ 1/2"	AN...S	44	616251120
□ 1/2"	A10RYA and A...RY	38	618251120

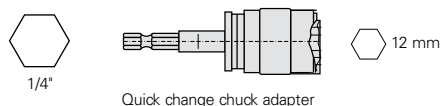

Drive	Code
Drive ○ for stud bolt holders – for insert holder	659011002

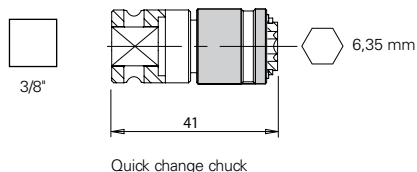

For	Code
AD6RA1	654141015
AD9RA1	
AD14RA1	
AD26RA1	

**Discover all tightening solutions
on Fiam website**

www.fiamgroup.com